

PRESTIGE

# Extend the swimming season

Thermeau® offers pool heaters with unmatched quality  
in terms of performance, durability, reliability  
and eco-friendliness for optimum comfort.



**THERMEAU**  
POOL HEAT PUMPS



PRESTIGE

## Thermeau®: The comfort you deserve

Invest in comfort to extend your swimming season, from the first signs of spring to cool autumn evenings. Designed in Canada, the PRESTIGE heat pump relies on our renowned North American technology to quickly deliver comfortable heating temperatures at low operating costs. Its unrivaled performance and reliability will give you the total peace of mind you're looking for.

- Best energy-efficiency performance in the industry
- Next-generation North American components
- Laboratory tests to accurately simulate climatic conditions
- Aesthetic yet resistant finish
- Superior soundproofing for greater discretion
- Quick and easy installation
- Accessible, personalized after-sales service

### UNSURPASSED ENERGY EFFICIENCY

Tested at an ambient temperature of 27°C (80°F), the Thermeau® pool heater generates a coefficient of performance (COP) of up to 6, meaning it produces up to 6 times more energy than it consumes.



5-year warranty on labor



5-year warranty on parts



10-year limited warranty on our heat exchanger

**AHRI CERTIFIED®**  
www.ahridirectory.org

Heat Pump Pool Heaters  
AHRI Standard 1160

### AHRI CERTIFICATION

Internationally recognized AHRI certification guarantees a high-performance, energy-efficient product with low environmental impact.

### INVEST IN LASTING COMFORT

Proud to design products that exceed the highest industry standards, Thermeau® offers a warranty program that ensures your peace of mind.



# Unequaled quality components

TH65 - TH85 - TH105 - TH125 - TH140B

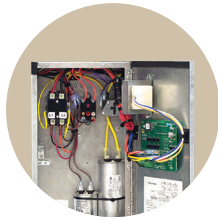

### Auto-diagnostic electronic thermostat

Accurately controls water temperature to the chosen degree  
For energy savings and comfort



### Copeland Scroll compressor: The best in the industry

The quietest system on the market  
Perfectly suited to all climates and environments  
Impressive combination of performance and energy savings  
High-quality, low-maintenance components

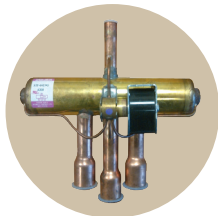

### Reversible defrost system

Extends the swimming season  
Continues to perform in colder temperatures



### Lockable panel

Better screen visibility on sunny days  
Greater safety and protection from the elements

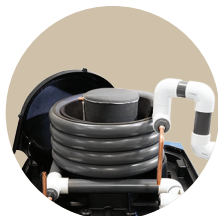

### Triple-action soundproofing

The quietest system available



### Profiled fan blade

Exclusive part improves ventilation  
Significantly reduces noise

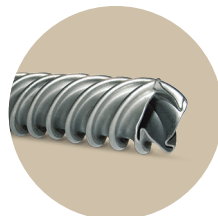

### Twisted titanium tube

Increases exchange surface area for better heat transfer  
Resistant to pool and spa chemicals



### Direct flow union

Drains water caused by condensation  
No more wet pavement!

# Features

## CHOOSE ONE OF OUR MAXIMUM-PERFORMANCE MODELS TO SUIT YOUR NEEDS

Operating specifications	TH65	TH85	TH105	TH125	TH140B
Volts	230	230	230	230	230
Hertz	60	60	60	60	60
Phase	1	1	1	1	1
Compressor amps	12.4A	17.2A	23.2A	24.3A	27.3A
Heat exchanger	Titanium / PVC	Titanium / PVC	Titanium / PVC	Titanium / PVC	Titanium / PVC
Fan motor max. load amps	2.4A	2.4A	2.4A	2.4A	2.4A
Fan motor HP	1/3	1/3	1/3	1/3	1/3
Fan motor speed	825 RPM	825 RPM	825 RPM	825 RPM	825 RPM
Minimum circuit ampacity	30 A	30 A	40 A	42,5 A	42,5 A
Maximum fuse	40 A	50 A	60 A	60 A	60 A
Compressor	Copeland Scroll	Copeland Scroll	Copeland Scroll	Copeland Scroll	Copeland Scroll

Test performance levels					
80F amb, 80F water, 80% RH	64,000 BTU/h	85,000 BTU/h	105,000 BTU/h	121,000 BTU/h	133,000 BTU/h
COP	6.3	6	6	5.5	6
80F amb, 80F water, 63% RH	60,000 BTU/h	80,000 BTU/h	100,000 BTU/h	116,000 BTU/h	126,000 BTU/h
COP	6,1	5,8	5,8	5,3	5,8
50F amb, 80F water, 63% RH	40,000 BTU/h	58,000 BTU/h	70,000 BTU/h	80,000 BTU/h	87,000 BTU/h
COP	4	4	4	4	4
Defrost	Hot gas	Hot gas	Hot gas	Hot gas	Hot gas
Refrigerant	R-410A	R-410A	R-410A	R-410A	R-410A
Optimal water flow rate (GPM)	30	35	40	55	60
Max. water flow rate (GPM)	100	100	100	100	100
Max. water temperature	104F	104F	104F	104F	104F
Net weight (lbs)	225	230	230	245	265
Shipping weight (lbs)	270	275	275	290	310
Dimensions (in.)	L: 39 W: 33 H: 34	L: 39 W: 33 H: 34	L: 39 W: 33 H: 34	L: 39 W: 33 H: 34	L: 39 W: 33 H: 34
Shipping dimensions (in.)	L: 44 W: 35 H: 39	L: 44 W: 35 H: 39	L: 44 W: 35 H: 39	L: 44 W: 35 H: 39	L: 44 W: 35 H: 39

### MODELS FOR ABOVE-GROUND POOLS

Dimensions (ft.)	Surface (ft. <sup>2</sup> )	Liters	Gallons US	Good	Better	Best
12	113	12,811	3,389	TH65	TH65	TH65
15	177	19,684	5,200	TH65	TH65	TH65
18	254	28,769	7,600	TH65	TH65	TH65
21	346	39,368	10,400	TH65	TH65	TH65
24	452	51,102	13,500	TH65	TH85	TH105
27	573	65,108	17,200	TH85	TH105	TH125
12 X 24	288	32,635	8,633	TH65	TH65	TH65
15 X 30	450	50,993	13,490	TH65	TH85	TH105
16 X 32	512	58,000	15,343	TH65	TH85	TH105
18 X 33	594	67,288	17,801	TH85	TH105	TH125

### MODELS FOR INGROUND POOLS

Dimensions (ft.)	Surface (ft. <sup>2</sup> )	Liters	Gallons US	Good	Better	Best
12 X 24	288	45,460	11,900	TH65	TH65	TH65
14 X 28	392	61,323	16,200	TH65	TH85	TH85
15 X 30	450	70,092	18,500	TH85	TH105	TH105
16 X 32	512	79,871	21,100	TH105	TH105	TH125
18 X 36	648	102,285	26,700	TH125	TH125	TH140B
20 X 40	800	124,918	33,000	TH140B	TH140B	TH140B

